

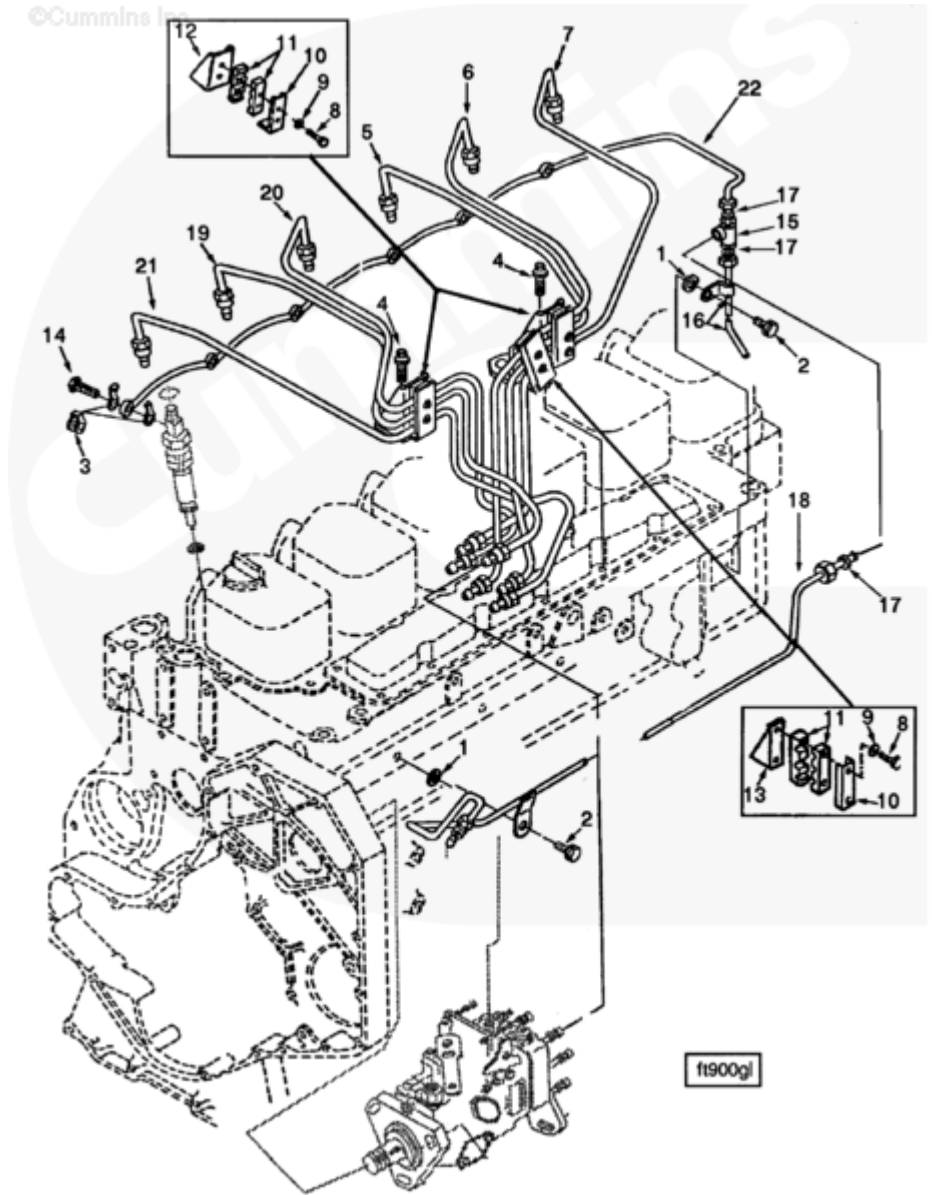

Parts Catalog - Option Detail

Electronic Parts Catalog - Option Detail				
Option	Group	Graphic	Film Card	Date
FT9780	06.03	ft900gl	T	27-JUL-96
Engines	4B3.9, 6A3.4, 6B5.9, B GAS INTERNATIONAL CM556, B4.5, B4.5 CM2350 B129B, B4.5 CM2350 B146C, B4.5 CM2350 B147B, B4.5 RGT, B4.5S, B5.9 G, B5.9 GAS PLUS CM556, B5.9 LPG, B5.9 LPG PLUS CM556, B6.7 CM2350 B121B, B6.7 CM2350 B135B, B6.7 CM2350 B136C, B6.7 CM2350 B148B, B6.7 G CMOH6.0 B125, B6.7N CM2380 B150B, B6.7S, F3.8 CM2350 F120B, F3.8 CM2350 F128C, F3.8 CM2350 F132B, F3.8 F102, G3.9, G5.9, G5.9 CM558, ISB (CHRYSLER), ISB CM2150, ISB CM2150 E, ISB CM550, ISB CM850, ISB/ISD4.5 CM2150 B119, ISB/ISD4.5 CM2150 SN, ISB/ISD6.7 CM2150 B120, ISB/ISD6.7 CM2150 SN, ISB/ISD6.7 CM2880 B126, ISB3.9 CM2220 B107, ISB4.5 CM2150, ISB5.9G CM2180, ISB6.7 2010 DCX PICKUP, ISB6.7 2013 DCX CHASSIS CAB, ISB6.7 CM2150 SQ, ISB6.7 CM2250, ISB6.7 CM2350 B101, ISB6.7 CM2350 B103, ISB6.7 CM2350 B142, ISB6.7 CM2670 B153B, ISB6.7 G CM2180 B118, ISBE CM2150, ISBE CM800, ISBE2/ISBE3 CM850, ISBE4 CM850, ISD4.5 CM2150, ISD6.7 CM2880 D101, ISF2.8 CM2220, ISF2.8 CM2220 AN, ISF2.8 CM2220 EC, ISF2.8 CM2220 ECF2, ISF2.8 CM2220 F101, ISF2.8 CM2220 F117, ISF2.8 CM2220 F122, ISF2.8 CM2220 F126, ISF2.8 CM2220 F129, ISF2.8 CM2220 IAN, ISF3.8 CM2220, ISF3.8 CM2220 AN, ISF3.8 CM2220 F103, ISF3.8 CM2220 F110, ISF3.8 CM2220 F116, ISF3.8 CM2220 F134B, ISF3.8 CM2220 IAN, ISF3.8 CM2350 F109, ISF4.5 CM2220 F123, ISG11 CM2880 G106, ISG11 CM2880 G108, ISG12 CM2880 G107, ISG12 CM2880 G109, ISG12 G CMOH6.0 G111, QSB3.9 30 CM550, QSB3.9 CM2880 B138, QSB4.5 30 CM550, QSB4.5 CM2150 B108, QSB4.5 CM2250 B131, QSB4.5 CM2250 EC, QSB4.5 CM2350 B106, QSB4.5 CM2350 B122			



SMALL | MEDIUM | LARGE

Cart	Ref No	Part Number	Part Description	Required	Remarks
View My Cart					
		FT9780	Fuel Plumbing		Fuel Plumbing...(More)
					Engine Family: B Series
					Engine Cylinders: 6
					High Pressure Tube ID.: 2.0
					Boost Control: Without
					Connection Type: Beadless
					Restricted Aspiration:
					Naturally Aspirated
					Turbocharged

					Fuel Pump Manufacturer/Model:
					CAV DPA
<input type="checkbox"/>	1	3928759	Grommet Seal	4	
<input type="checkbox"/>	2	3900629	Hexagon Flange Head Cap Screw	2	M8 X 1.25 X 16
	3	3903380	Banjo Connector Seal	6	Replace With 4942278
<input type="checkbox"/>	4	3918109	Hexagon Flange Head Cap Screw	2	M8 x 1.25 x 25
<input type="checkbox"/>	5	3914050	Injector Fuel Supply Tube	1	#4 Cylinder
<input type="checkbox"/>	6	3914051	Injector Fuel Supply Tube	1	#5 Cylinder
<input type="checkbox"/>	7	3914052	Injector Fuel Supply Tube	1	#6 Cylinder
	8	3917712	Hexagon Head Cap Screw	6	M5 X 0.80 X 22
<input type="checkbox"/>	9	3903723	Plain Washer	6	
<input type="checkbox"/>	10	3904519	Tube Brace	3	
<input type="checkbox"/>	11	3917747	Vibration Isolator	6	
<input type="checkbox"/>	12	3917778	Tube Brace	2	
<input type="checkbox"/>	13	3282942	Tube Brace	2	
<input type="checkbox"/>	14	3905307	Banjo Connector Screw	6	M6 X 1.00 X 14.3
<input type="checkbox"/>	15	3905388	Male Union Tee	1	
<input type="checkbox"/>	16	3905692	Fuel Drain Tube	1	
<input type="checkbox"/>	17	3905391	Grommet Seal	1	
<input type="checkbox"/>	18	3905709	Fuel Drain Tube	1	
<input type="checkbox"/>	17	3905391	Grommet Seal	1	
<input type="checkbox"/>	19	3914048	Injector Fuel Supply Tube	1	#2 Cylinder
<input type="checkbox"/>	20	3914049	Injector Fuel Supply Tube	1	#3 Cylinder
<input type="checkbox"/>	21	3914047	Injector Fuel Supply Tube	1	#1 Cylinder
<input type="checkbox"/>	22	3909696	Fuel Manifold	1	
<input type="checkbox"/>	17	3905391	Grommet Seal	1	